

Mortise Cylinder Lock Tap & Die Set

When mortise cylinders and lock cases are new they screw together without a problem. Often times a mortise cylinder is forced out of a lock without loosening the retaining screw. Other times an inexperienced person will force a mortise cylinder into a lock crooked. These actions result in stripping the threads of the cylinder or the lock case itself. The HPC **Mortise Cylinder Lock Tap & Die Set** was designed to repair this type of damage. **The Tap can be easily twisted into a stripped lock case** cutting new usable threads into an otherwise ruined lock. The Holding Fixture **secures a stripped mortise cylinder in your vise** while you use the die to repair the threads. The tap and die are also available separately.

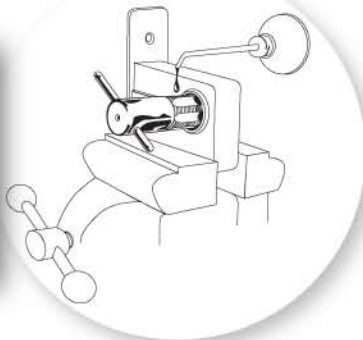
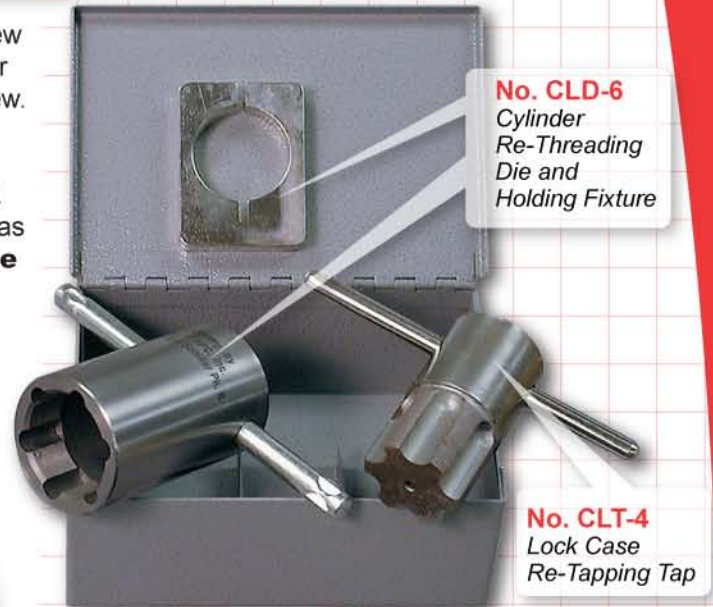

Mortise Cylinder Lock Tap & Die Set

No. CLTD-5

Complete Re-Tapping Kit with
Cylinder Holding Fixture and Metal Box

Double "D" Metal Punch & Die Set

HPC's **Double "D" Metal Punch & Die Set** punches a double "D" hole. It is a necessary tool for locksmiths **installing cam locks on metal cabinets, desks, sheet metal lockers, filing cabinets and cash boxes** made of single wall, sheet metal of 18-gauge or lighter. This tool punches a .645" x .770" (16.4 x 19.5mm) hole in 18-gauge (.048"/1.2mm) mild steel.



Double "D" Metal Punch & Die Set

No. HDPS-4

